

# DRIVE AXLE

## SERVICE TOOLS – OTHER SUPPLIER

Description	Part Number	Page
SNAP-ON 3-JAW PULLER .....	CG273 .....	3

## SERVICE PRODUCTS

Description	Part Number	Page
SUSPENSION GREASE .....	293 550 033 .....	4

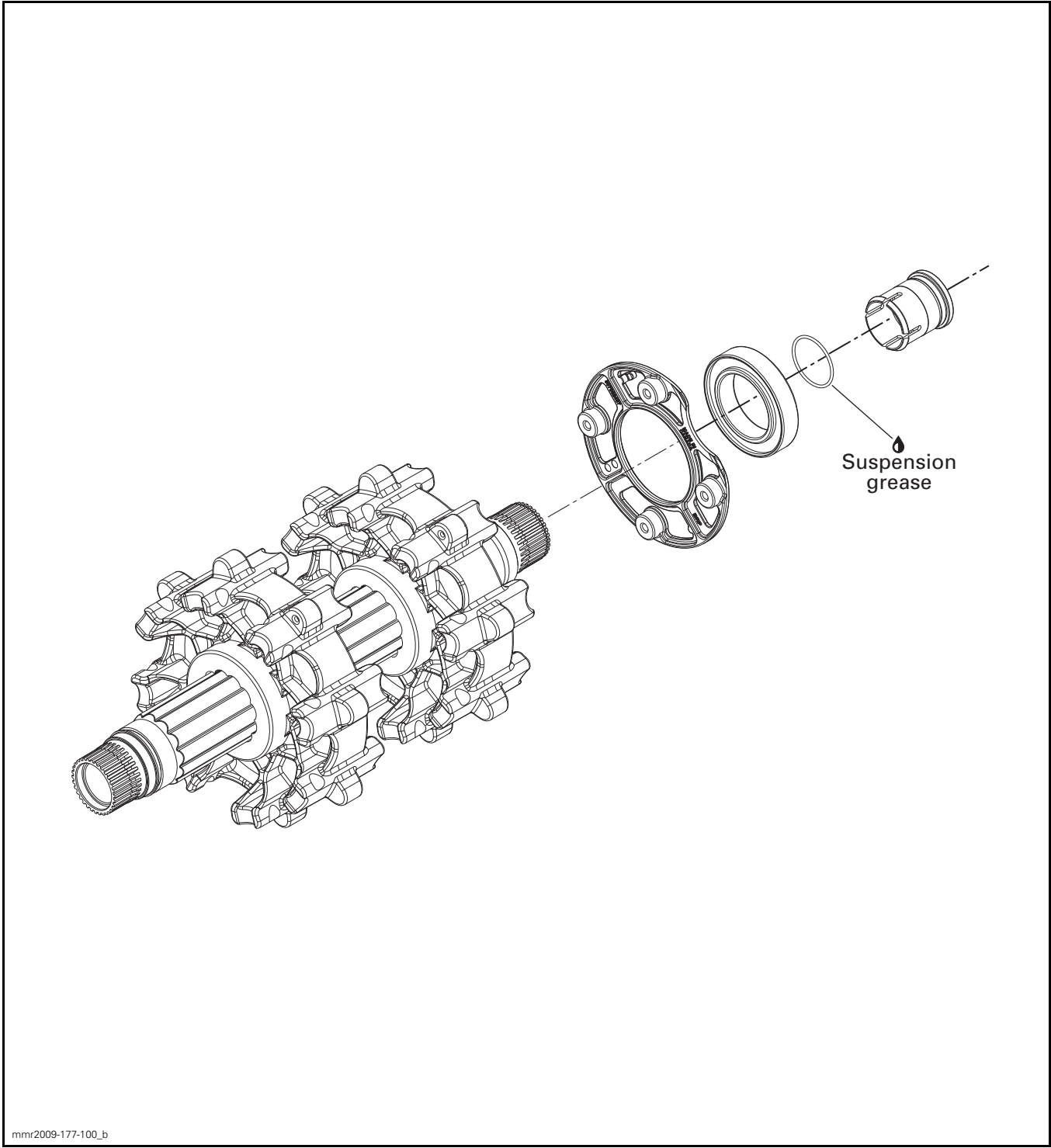

mmr2009-177-100\_b

## GENERAL

During assembly/installation, use torque values and service products as in the exploded view.

Clean threads before applying a threadlocker. Refer to *SELF-LOCKING FASTENERS* and *LOCTITE APPLICATION* at the beginning of this manual for complete procedure.

### ⚠ WARNING

Torque wrench tightening specifications must be strictly adhered to. Locking devices must be replaced with new one when removed (e.g.: locking tabs, elastic stop nuts, cotter pins, etc.).

## PROCEDURES

### DRIVE AXLE

#### Drive Axle Removal

1. Remove the rear suspension. Refer to *REAR SUSPENSION* subsection.
2. Remove the brake caliper. Refer to *BRAKE* subsection.
3. From underneath of vehicle, turn the LH bearing flange counterclockwise to unlock it from frame.
4. Release drive axle sprockets from track.
5. Move drive axle toward the LH side to release it from gearbox.
6. Move drive axle downwards to remove its RH side out of frame.

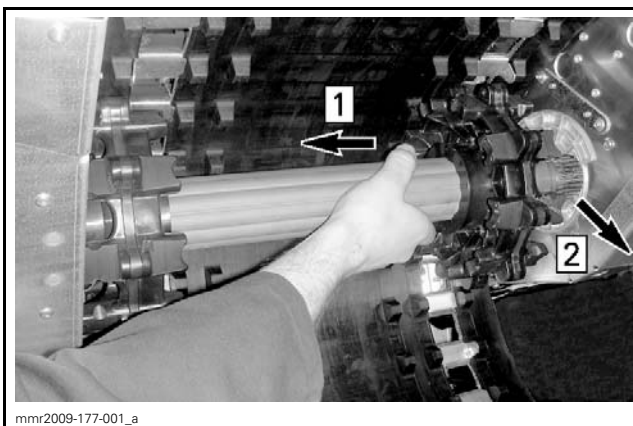

Step 1: Move toward the LH side (opposite to gearbox)  
Step 2: Move downwards

**NOTE:** The drive axle may be very tight between tunnel sides. Ensure to completely move axle toward the LH side (opposite to gearbox) to provide enough clearance to release it from the frame.

#### Drive Axle Inspection

Check if bearing turns smoothly and freely. Replace if necessary.

Check if bearing seals are damaged. Replace if necessary.

Check if the bearing flange is cracked, bent or otherwise damaged. Replace if necessary.

Replace drive axle if one of the following situations is detected:

- Cracked, worn or damaged drive axle
- Worn or damaged drive axle splines
- Worn or damaged sprockets
- Worn bearing journal.

#### Drive Axle Bearing Removal

1. Remove drive axle from vehicle. Refer to *DRIVE AXLE REMOVAL* in this subsection.
2. Remove O-ring.

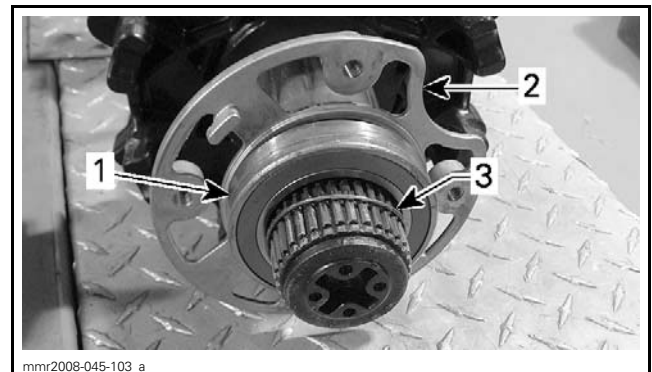

1. Drive axle bearing  
2. Bearing flange  
3. O-ring

3. Using a 3 legs jaw puller such as the SNAP-ON 3-JAW PULLER (P/N CG273), remove the drive axle bearing.

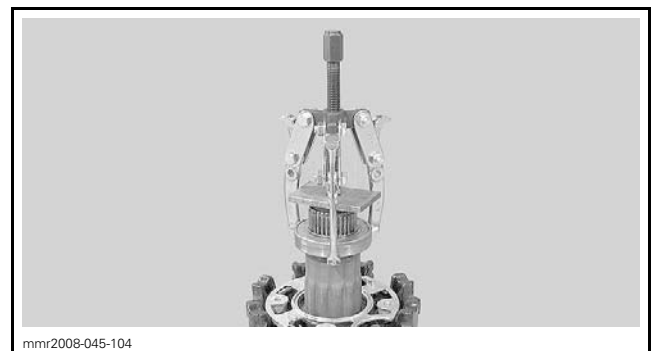

4. Remove the bearing flange.

Drive Axle Bearing Installation

- 1. Install bearing flange on drive axle with locking tabs outwards.

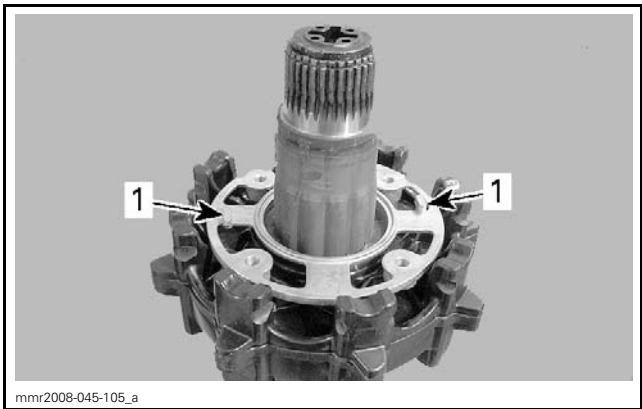

1. Locking tabs outwards

- 2. Using a press and a suitable pipe, push the bearing onto drive axle.

**NOTICE** Always push the bearing by inner race.

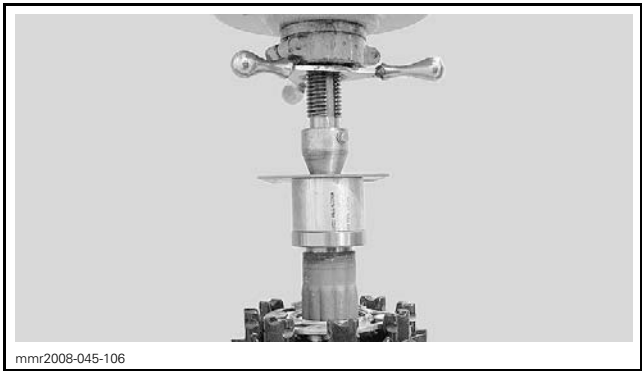

Drive Axle Installation

The installation is the reverse of the removal procedure. However, pay attention to the following. Install drive axle and lock the bearing flange on frame.

**NOTICE** Locking tabs must be properly inserted and locked into frame slots.

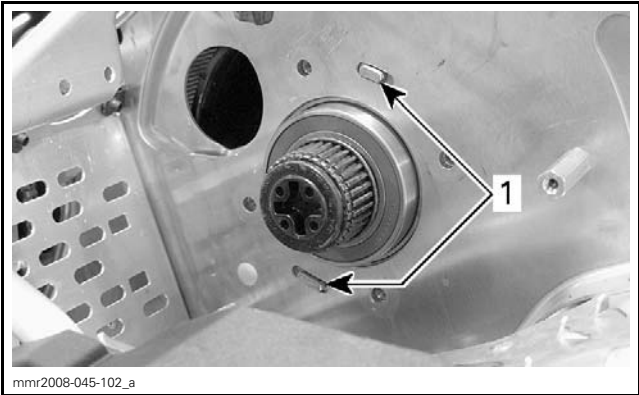

VIEW FROM OUTSIDE FRAME

1. Bearing flange locking tabs

- 1. Install the caliper and the disc brake. Refer to *BRAKE* subsection for the specific procedure.
- 2. Install all other removed parts. Refer to appropriate subsections.

MAGNETIC CAP

Magnetic Cap Removal

For the LH side cap, remove the protective cover of the brake disc. Refer to *BRAKE* subsection.

- 1. Using 2 screwdrivers or pliers, pry or pull the magnetic cap out of drive axle end.
- 2. Discard the magnetic cap.

Magnetic Cap Installation

The installation is the reverse of the removal procedure. However, pay attention to the following.

Apply SUSPENSION GREASE (P/N 293 550 033) on O-ring.